

Technical datasheet for shoe and boot cleaner flush to the floor, 4, 6, 8, 12, 16 or 24 stations

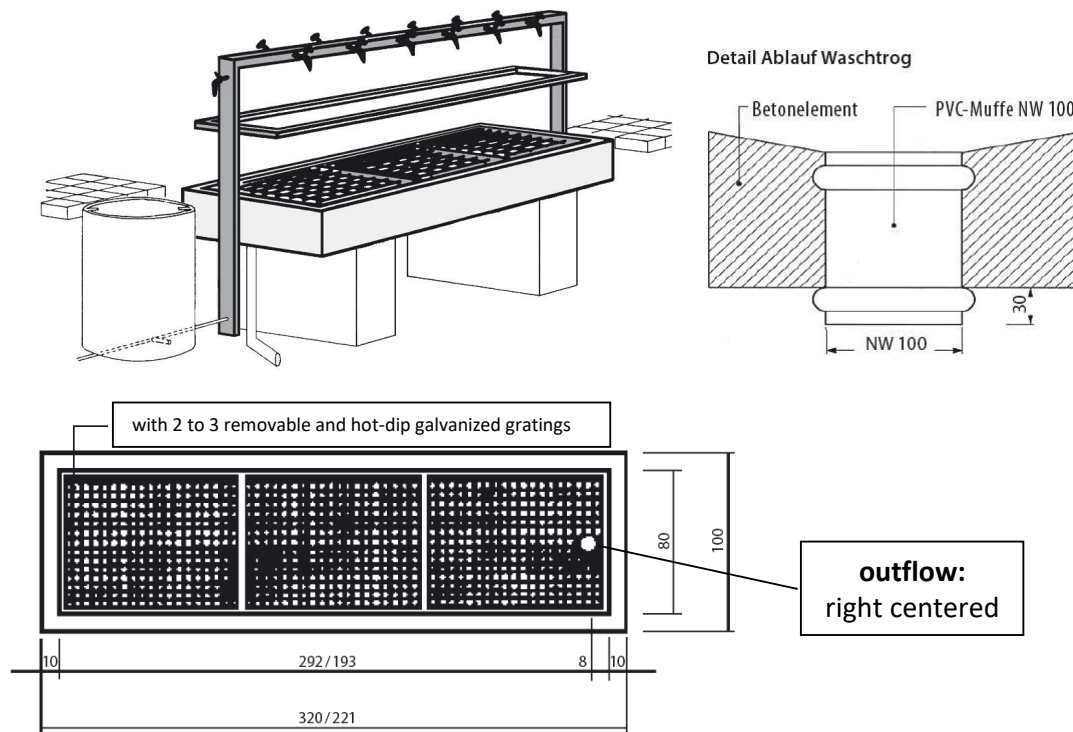

Notes:

- Please let us know if the connection and drain should be installed left or right (see drawing)
- Pipes and washing frame should be flushed before initial use
- Max. line pressure is 5 bar
- Install fine filters in the supply line
- The line withstands an operating pressure of max. 6 bar. If an increased pressure is present, a pressure reducing valve must be installed by the customer
- If there is a risk of frost, the pipe must be emptied
- The prices do not include preparatory work on site, installation and transport. Installation must be carried out by a local plumber/construction company
- Faucets are not included. Under accessories you will find a number of possible taps and washing brushes
- Before installation, foundation / support, water connection and sewerage connection with sludge collector must be installed by the customer

Shoe and boot cleaner flush to the floor

4 stations, one sided

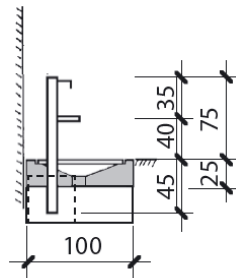
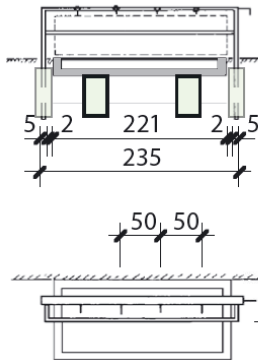

- 1 Waschtrog Betonelement
- 2 Gitterroste
- 1 Waschbügel Typ B21
- 4 Wasserhähnen
- 1 Schlauchanschluss
- Gewicht 990 kg

6 stations, one sided

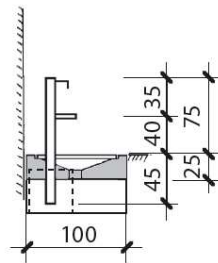
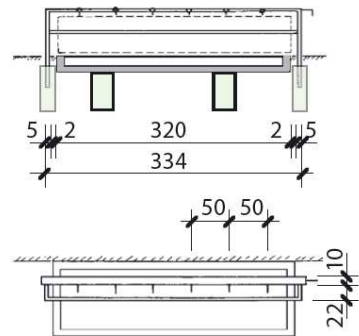

- 1 Waschtrog Betonelement
- 3 Gitterroste
- 1 Waschbügel Typ B11
- 6 Wasserhähnen
- 1 Schlauchanschluss
- Gewicht 1 485 kg

8 stations, one sided

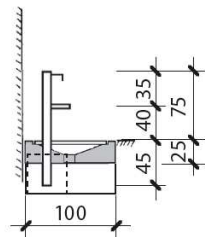
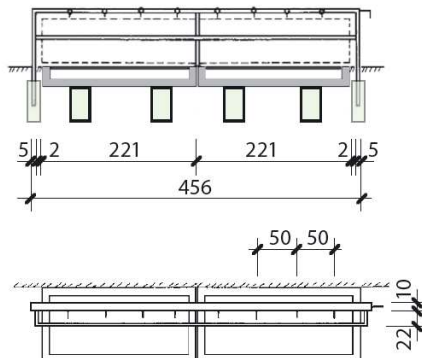

- 2 Waschröge Betonelement
- 4 Gitterroste
- 1 Waschbügel Typ B23
- 8 Wasserhähnen
- 1 Schlauchanschluss
- Gewicht 1 970 kg

12 stations, one sided

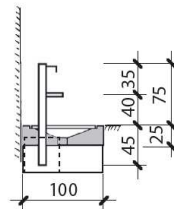
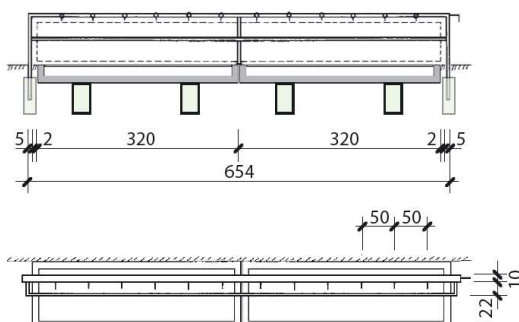

- 2 Waschröge Betonelement
- 6 Gitterroste
- 1 Waschbügel Typ B13
- 12 Wasserhähnen
- 1 Schlauchanschluss
- Gewicht 2 956 kg

8 stations, double sided

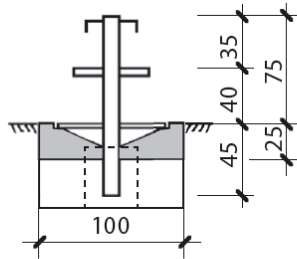
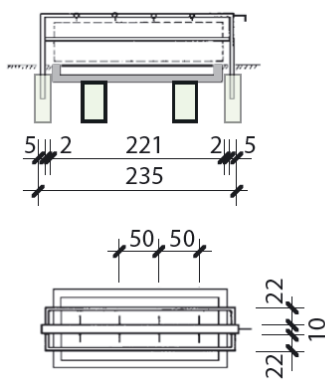

- 1 Waschtrog Betonelement
- 2 Gitterroste
- 1 Waschbügel Typ B22
- 8 Wasserhähnen
- 1 Schlauchanschluss
- Gewicht 998 kg

12 stations, double sided

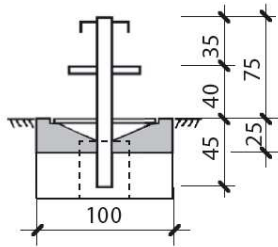
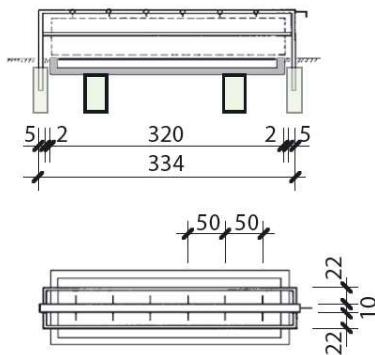

- 1 Waschtrog Betonelement
- 3 Gitterroste
- 1 Waschbügel Typ B12
- 12 Wasserhähnen
- 1 Schlauchanschluss
- Gewicht 1 498 kg

16 stations, double sided

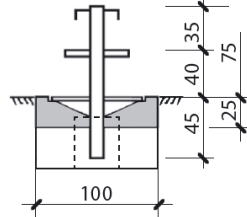
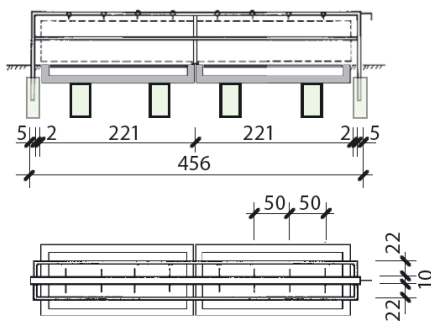

- 2 Waschröge Betonelement
- 4 Gitterroste
- 1 Waschbügel Typ B24
- 16 Wasserhähnen
- 1 Schlauchanschluss
- Gewicht 1 986 kg

24 stations, double sided

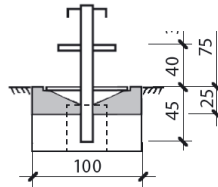
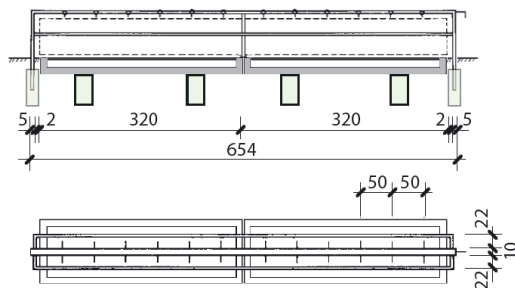



- 2 Waschröge Betonelement
- 6 Gitterroste
- 1 Waschbügel Typ B14
- 24 Wasserhähnen
- 1 Schlauchanschluss
- Gewicht 2 980 kg

Positioning: one-sided installations

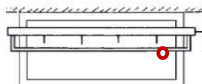
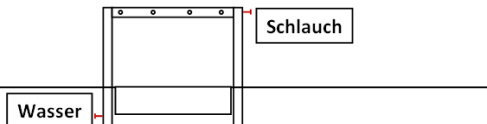
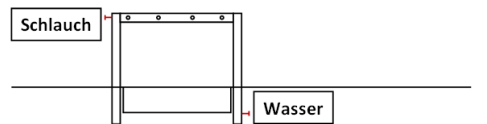

Standard - positioning water connection and drain:

Please check the corresponding red boxes (☐) for the desired installation.

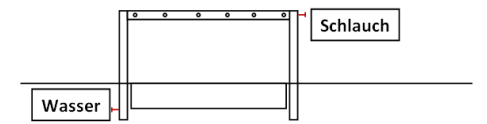
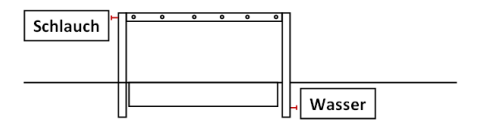
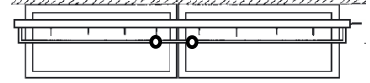
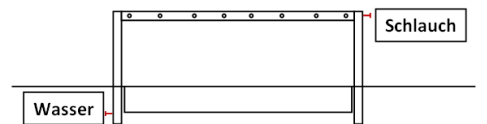
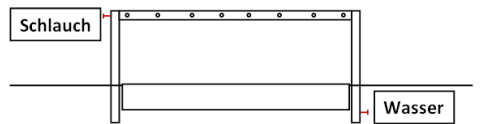
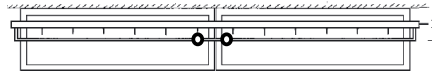
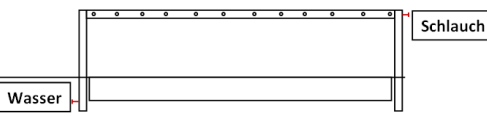
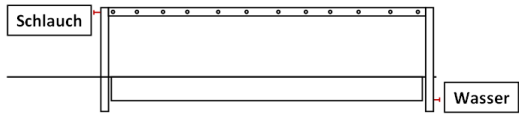



Shoe and boot cleaner	Wateroutflow	Waterinflow	
4 stations, one-sided	<input type="checkbox"/> left centered right centered <input type="checkbox"/>  	<input type="checkbox"/> left 	right <input type="checkbox"/> 
6 stations, one-sided	<input type="checkbox"/> left centered right centered <input type="checkbox"/>  	<input type="checkbox"/> left 	right <input type="checkbox"/> 
8 stations, one-sided	both centered as a standard 	<input type="checkbox"/> left 	right <input type="checkbox"/> 
12 stations, one-sided	both centered as a standard 	<input type="checkbox"/> left 	right <input type="checkbox"/> 
Please fill out & sign →	Date: _____	Name: _____ Signature: _____	

Positioning: double-sided installations

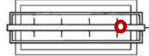
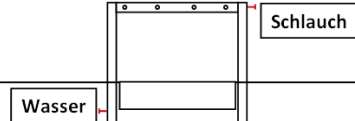
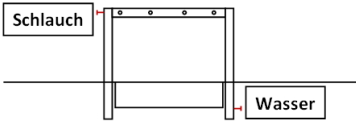

Standard - positioning water connection and drain:

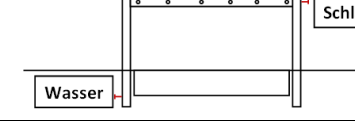
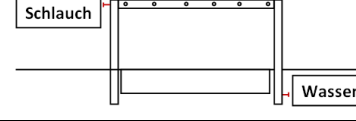
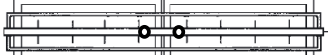
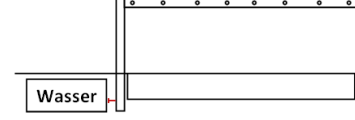
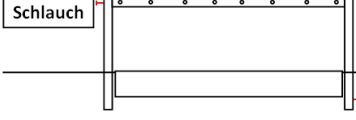
Please check the corresponding red boxes (☐) for the desired installation.

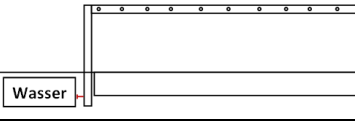
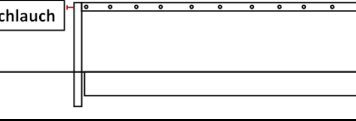
Shoe and boot cleaner	Wateroutflow	Waterinflow	
8 Reinigungsplätze doppelseitig	<input type="checkbox"/> left centered right centered <input type="checkbox"/>  	<input type="checkbox"/> left 	right <input type="checkbox"/> 
12 Reinigungsplätze doppelseitig	<input type="checkbox"/> left centered right centered <input type="checkbox"/>  	<input type="checkbox"/> left 	right <input type="checkbox"/> 
16 Reinigungsplätze doppelseitig	both centered as a standard 	<input type="checkbox"/> left 	right <input type="checkbox"/> 
24 Reinigungsplätze doppelseitig	both centered as a standard 	<input type="checkbox"/> left 	right <input type="checkbox"/> 
Please fill out & sign →	Date: _____	Name: _____ Signature: _____	