

Technical datasheet for Shoe washing station above-ground, 4, 8 or 16 stations

Grundriss

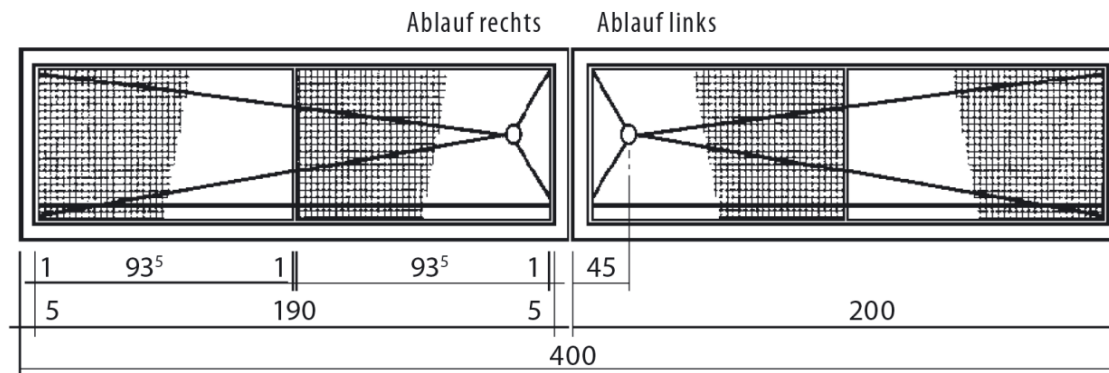

Querschnitt

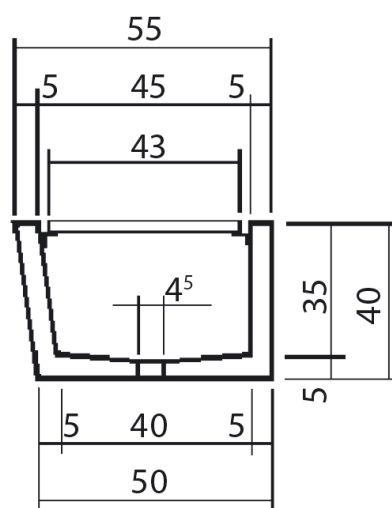

Detail Ablauf Waschtrog

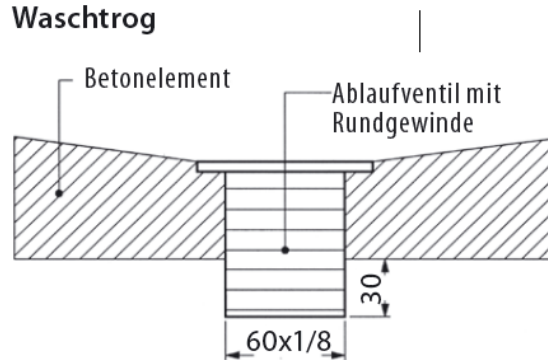

Ablauf mit Aussenge-
 winde, Typ Geberit
 Art. Nr. 352.330.08.1

Blue Level GmbH
Säntisstrasse 17
CH-8280 Kreuzlingen
Switzerland



eShop: www.schuhputzmaschine.ch
eMail: info@bluelevel.ch

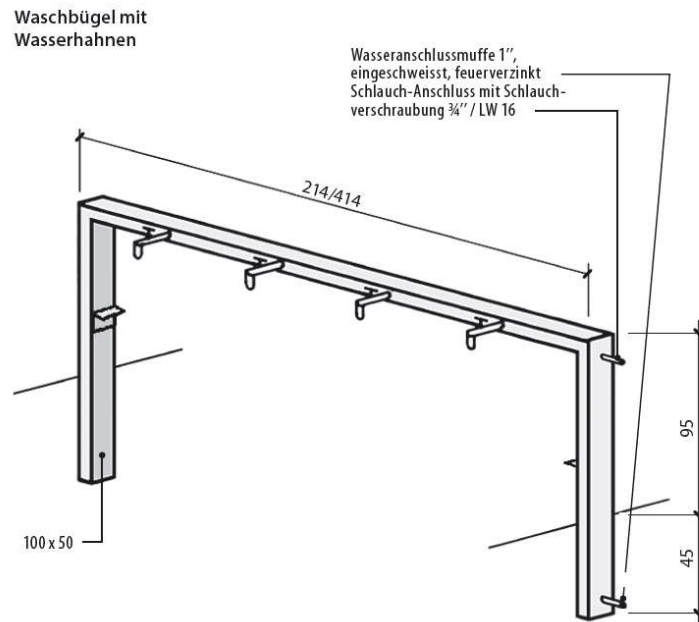

Notes:

- When ordering, please let us know whether the drain is desired on the left or right, as well as the water connection (see drawing)
- The sinks can also be recessed
- Flush pipes and washing frame before start-up
- Max. Line pressure 5 bar
- Install fine filters in the supply line
- The line withstands an operating pressure of max. 6 bar. If an increased pressure is present, a pressure reducing valve must be installed on site
- The pipes must be emptied if there is a risk of frost
- Faucets are not included. Under accessories you will find a number of possible taps and washing brushes
- The prices do not include preparatory work on site, installation and transport. Installation must be carried out by a local plumber/construction company
- Foundation / support, water connection and drain with sludge collector must be installed by the customer before installation

Säntisstrasse 17
CH-8280 Kreuzlingen
Switzerland

eShop: www.schuhputzmaschine.ch

eMail: info@bluelevel.ch

Shoe washing station above-ground, single-sided with 4 stations



1 Betonelement
einseitig nutzbar

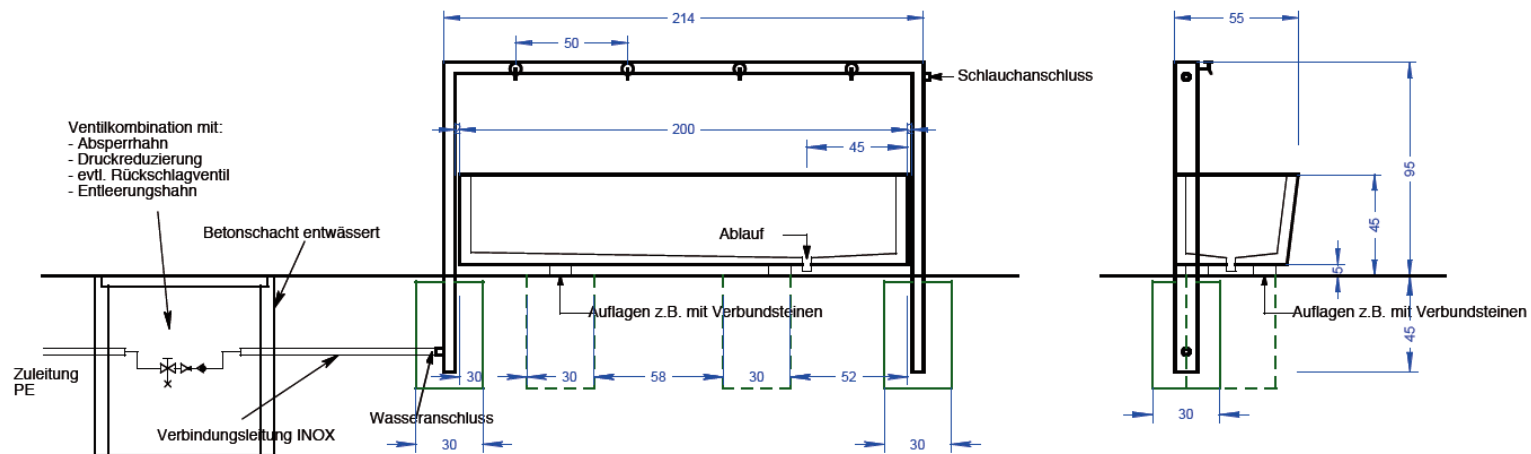
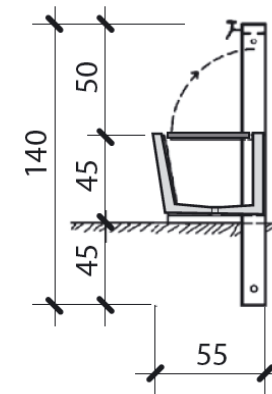
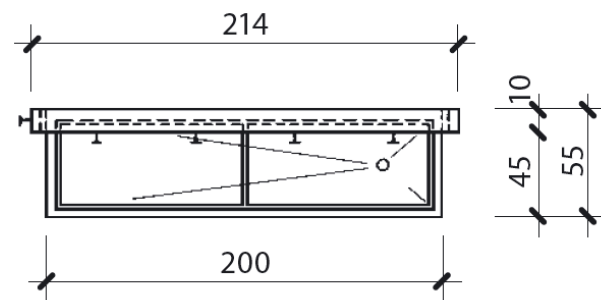

Blue Level GmbH

Säntisstrasse 17

CH-8280 Kreuzlingen

Switzerland

eShop: www.schuhputzmaschine.ch

eMail: info@bluelevel.ch

Shoe washing station above-ground, single-sided with 8 stations



2 Betonelement
einseitig nutzbar

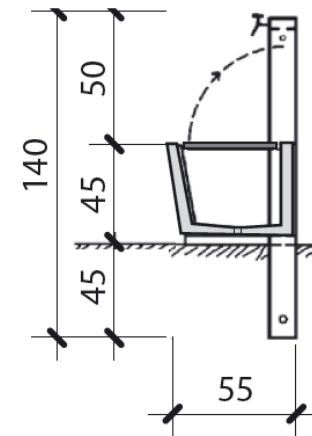
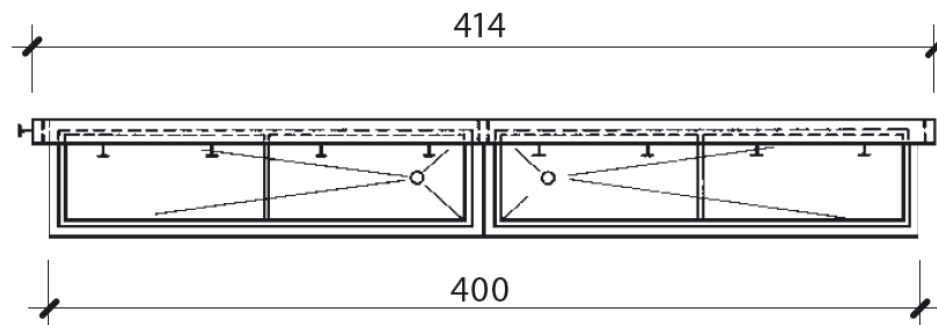

Blue Level GmbH

Säntisstrasse 17

CH-8280 Kreuzlingen

Switzerland

eShop: www.schuhputzmaschine.ch

eMail: info@bluelevel.ch

Shoe washing station above-ground, double-sided with 8 stations



2 Betonelemente
doppelseitig nutzbar

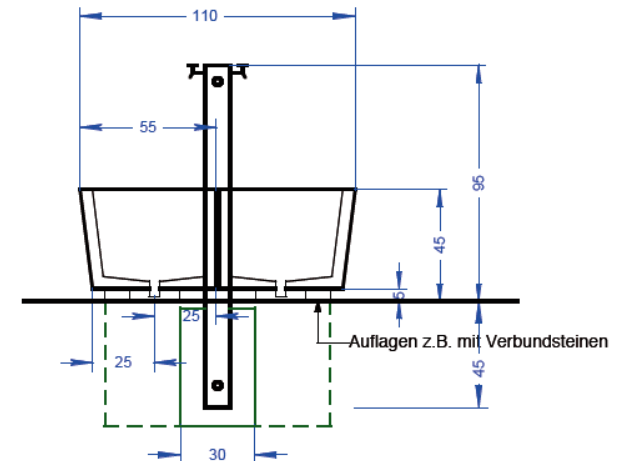
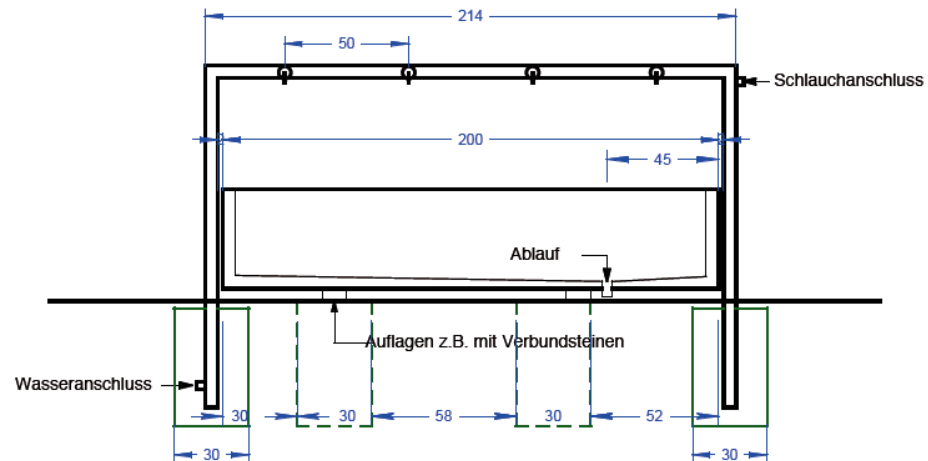
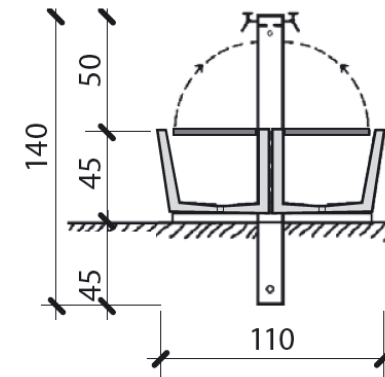
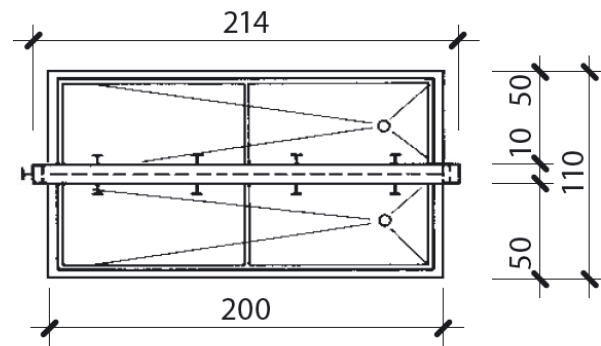

Blue Level GmbH

Säntisstrasse 17

CH-8280 Kreuzlingen

Switzerland

eShop: www.schuhputzmaschine.ch

eMail: info@bluelevel.ch

Shoe washing station above-ground, double-sided with 16 stations



4 Betonelemente
doppelseitig nutzbar

